

M 1:1

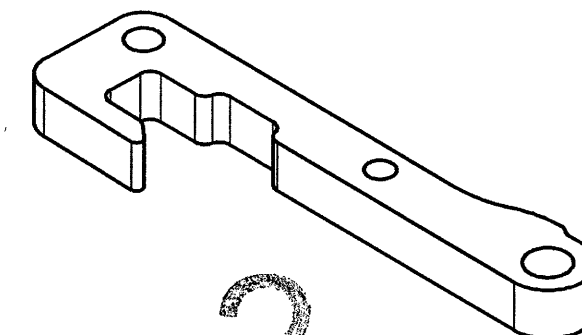

- 6 -02- 2018
ARCHIV

2

LM/18/00036

STAV DODÁNÍ:
BEZ OTŘEPŮ

Condition at time of delivery	
de-scaled (degree of purity SA 2 1/2 acc. ISO 8501-1)	--
without burrs acc. WN 11310	X
Permissible top-end rounding during flame cutting (also positive bead acc. WN 10572)	--
oil-free / free of grease	--
oiled	--
oiling permissible	--
Indicate the required condition at time of delivery with an X.	

VŠECHNY NEKOTOVANÉ
POLOHÉRY R2
All undimensioned radii R2

02 DIN 50979-ZnFe12/Fn/IT2

-0.5
-1

First angle projection	02	change the coatings to Cr(VI)-free coatings	T92691														
General tolerance (GT) in mm	ZMĚNA POVRCHOVÉ ÚPRAVY																
Size range	Index alteration Change no Fit Toler.																
<table border="1"> <tr> <td>> 30</td> <td>> 120</td> <td>> 400</td> <td>> 1000</td> </tr> <tr> <td>≤ 30</td> <td>≤ 120</td> <td>≤ 400</td> <td>≤ 1000</td> </tr> </table>	> 30	> 120	> 400	> 1000	≤ 30	≤ 120	≤ 400	≤ 1000	PPAP -		Material: S235JR		Weight: in kg				
> 30	> 120	> 400	> 1000														
≤ 30	≤ 120	≤ 400	≤ 1000														
GT fine	Inspection dim.	Aux.dim. ()	Blank no:		0.09												
<table border="1"> <tr> <td>L</td> <td>0,2</td> <td>0,5</td> <td>0,8</td> <td>2</td> <td>4</td> </tr> <tr> <td>≤</td> <td>0,1</td> <td>0,2</td> <td>0,4</td> <td>1</td> <td>2</td> </tr> </table>	L	0,2	0,5	0,8	2	4	≤	0,1	0,2	0,4	1	2	Date	Name	Title:		Prod.
L	0,2	0,5	0,8	2	4												
≤	0,1	0,2	0,4	1	2												
Lengths (L) and angle (∠) = ±GT	Drawn	13.04.2017	lever		Scale												
Tolerance Symbols ISO 1101	Checked	20.06.2017			5:1												
○ roundness = 1/2σ-Tol.	Auth'd	20.07.2017			Sheet:												
□ straightness/flatness = AT	M.check	24.07.2017			1												
◎ concentricity/run out = AT					of:												
≡ symmetry = AT					1												
// parallelism = AT																	
⊕ position = AT																	
Languages: DE;EN	Confidential document		Repl.		Orig.												
	Refer to protection notice ISO 16016																

Released

1444367/D2D/001/02

A3

55042020504_V02END001
55042020504_DRW_000_02062nt e1sap304 DE7CA7 2017-12-12T08:41:26 1.000